

RETAIL SPACE AVAILABLE

For Lease



1,420 Salon Space & 1,650 Sq Ft Retail End Cap Space
95th Street & Nall Avenue (SWC) | 5695 - 5701 W. 95th St., Overland Park, Kansas



Estimated Population
245,844

Average Household Income
\$85,596

Five Mile Radius

- Great for office or retail space
- Perfect for many concepts including coffee shop, deli, ice cream, etc.
- Desired end cap space location
- Intersection carries over 45,000 cars per day

BLOCK & COMPANY, INC., Realtors 816.753.6000
In the Skelly Building on the Country Club Plaza
605 West 47th Street, Suite 200, Kansas City, Missouri 64112

For Information Contact:

Darren Siegel
816.412.7377
dsiegel@blockandco.com

Phil Peck
816.412.7364
ppeck@blockandco.com

95th Street & Nall Avenue | 5695 - 5701 W. 95th Street, Overland Park, Kansas



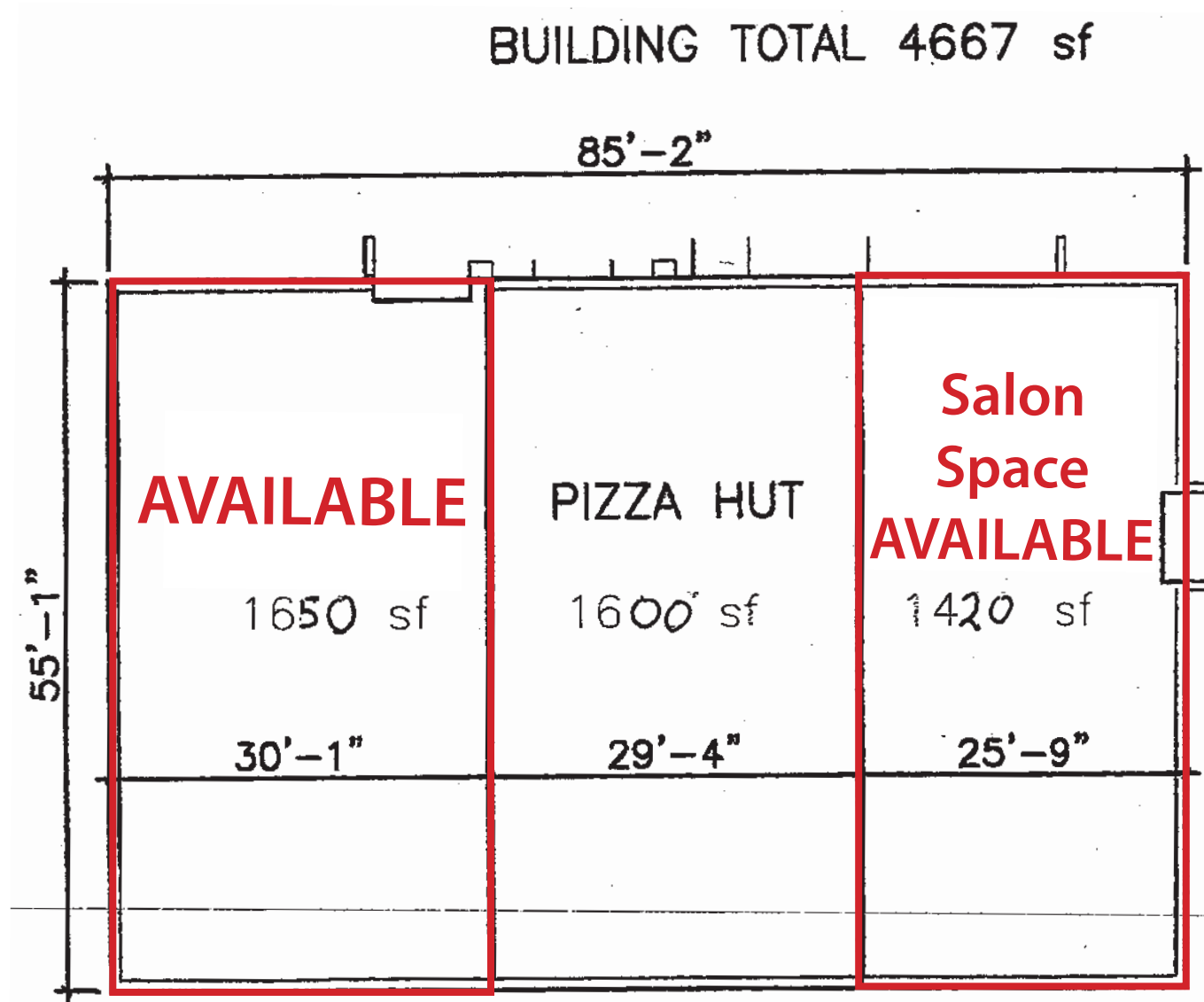

Lat: 38.9564 Lon: -94.6524 Zoom: 11.01 mi Logos are for identification purposes only and may be trademarks of their respective companies.

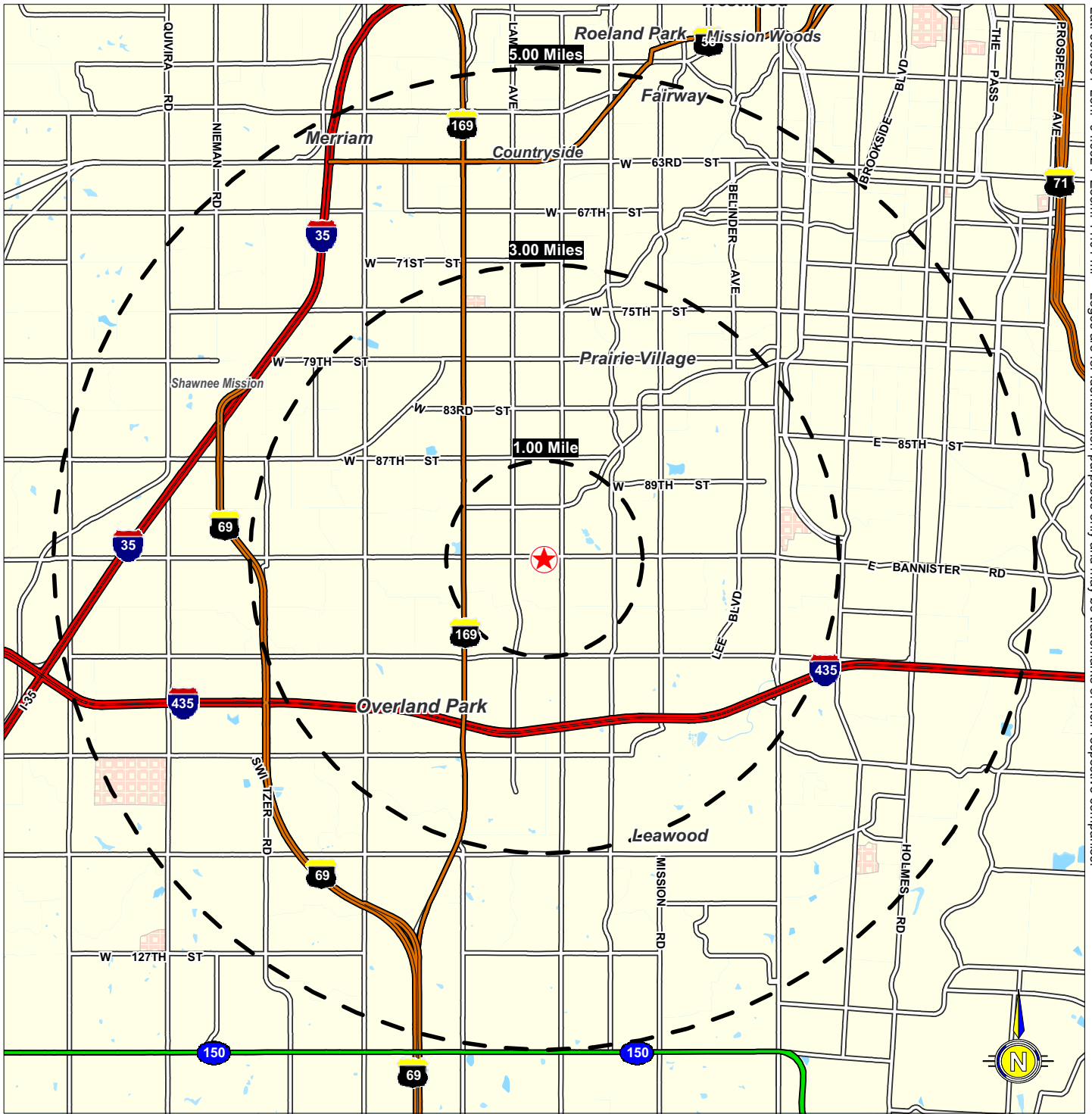

©2010, SITES USA Inc., Chandler, AZ (480) 491-1112. All Rights Reserved.

5701 W. 95th Street Overland Park, Kansas

April 2010

This map was produced using data from private and government sources deemed to be reliable. The information herein is provided without representation or warranty.

SUMMARY DEMOGRAPHIC PROFILE

1990 - 2000 Census, 2009 Estimates & 2014 Projections

Calculated using Proportional Block Groups

Lat/Lon: 38.956406/-94.652351

April 2011

RS1

5701 W. 95th Street Overland Park, Kansas		1.00 mi radius	3.00 mi radius	5.00 mi radius
POPULATION	2009 Estimated Population	10,892	86,128	245,844
	2014 Projected Population	10,847	87,753	247,878
	2000 Census Population	11,404	87,750	247,857
	1990 Census Population	11,935	89,856	238,815
	Historical Annual Growth 1990 to 2009	-0.5%	-0.2%	0.2%
	Projected Annual Growth 2009 to 2014	-0.1%	0.4%	0.2%
	2009 Median Age	47.2	43.8	41.2
HOUSEHOLDS	2009 Estimated Households	4,502	36,004	103,261
	2014 Projected Households	4,117	33,875	97,381
	2000 Census Households	4,897	38,139	107,623
	1990 Census Households	4,884	37,144	99,703
	Historical Annual Growth 1990 to 2009	-0.4%	-0.2%	0.2%
	Projected Annual Growth 2009 to 2014	-1.7%	-1.2%	-1.1%
POPULATION BY RACE	2009 Estimated White	88.0%	86.5%	83.5%
	2009 Estimated Black or African American	3.7%	4.6%	7.8%
	2009 Estimated Asian & Pacific Islander	3.1%	3.3%	3.3%
	2009 Estimated American Indian & Native Alaskan	0.6%	0.6%	0.6%
	2009 Estimated Other Races	4.6%	5.0%	4.9%
	2009 Estimated Hispanic	5.4%	6.6%	6.5%
INCOME	2009 Estimated Average Household Income	\$ 80,544	\$ 81,837	\$ 85,596
	2009 Estimated Median Household Income	\$ 79,997	\$ 75,362	\$ 78,707
	2009 Estimated Per Capita Income	\$ 33,380	\$ 34,802	\$ 36,614
EDUCATION (AGE 25+)	2009 Elementary	0.5%	1.1%	1.1%
	2009 Some High School	1.6%	2.2%	2.5%
	2009 High School Graduate	15.3%	16.9%	16.6%
	2009 Some College	22.8%	22.5%	21.0%
	2009 Associates Degree Only	5.5%	6.3%	6.8%
	2009 Bachelors Degree Only	33.0%	33.1%	33.5%
	2009 Graduate Degree	21.3%	17.9%	18.6%
BUSINESS	Number of Businesses	500	6,267	14,974
	Total Number of Employees	5,294	86,552	220,223
	Employee Population per Business	10.6	13.8	14.7
	Residential Population per Business	21.8	13.7	16.4

This report was produced using data from private and government sources deemed to be reliable. The information herein is provided without representation or warranty.