

# DAYCARE FACILITY AVAILABLE

## For Sale or For Lease



**7,720 +/- Sq Ft Building on 33,000 Sq Ft of Land**  
**2100 N. M-7 Highway, Blue Springs, Missouri**



Estimated Population  
**75,278**

Average Household Income  
**\$70,958**

Five Mile Radius

- Ample parking
- Located north of I-70 & M-7 Highway
- Great visibility from M-7 Highway
- M-7 Highway carries over 32,000 cars per day

BLOCK & COMPANY, INC., Realtors  
4963 NE Goodview Circle, Suite C  
Lee's Summit, Missouri 64064

816.753.6000

For Information Contact:

**William Glasgow**  
816.412.7210  
wglasgow@blockandco.com

# 2100 N. M-7 Highway, Blue Springs, Missouri

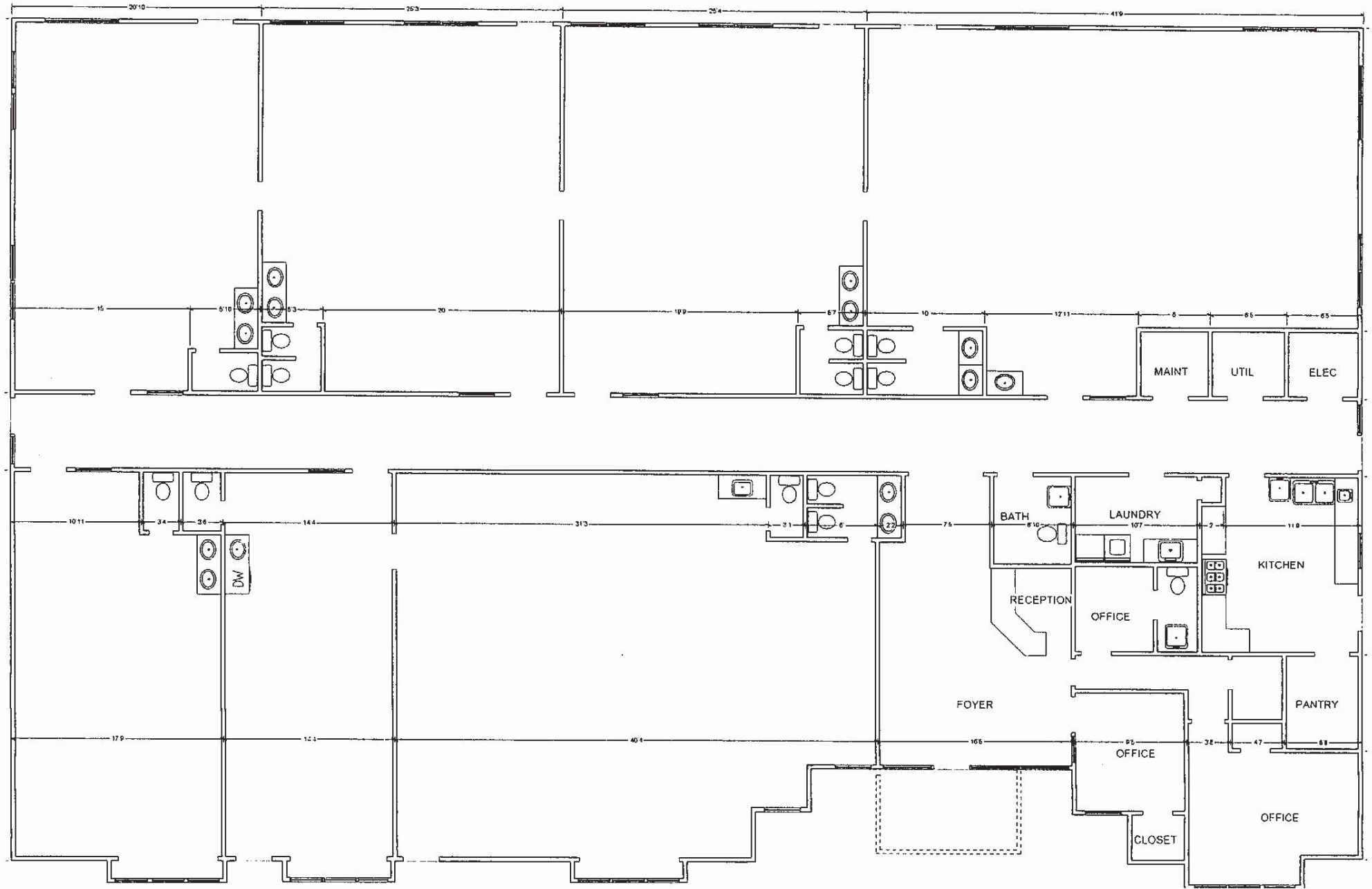

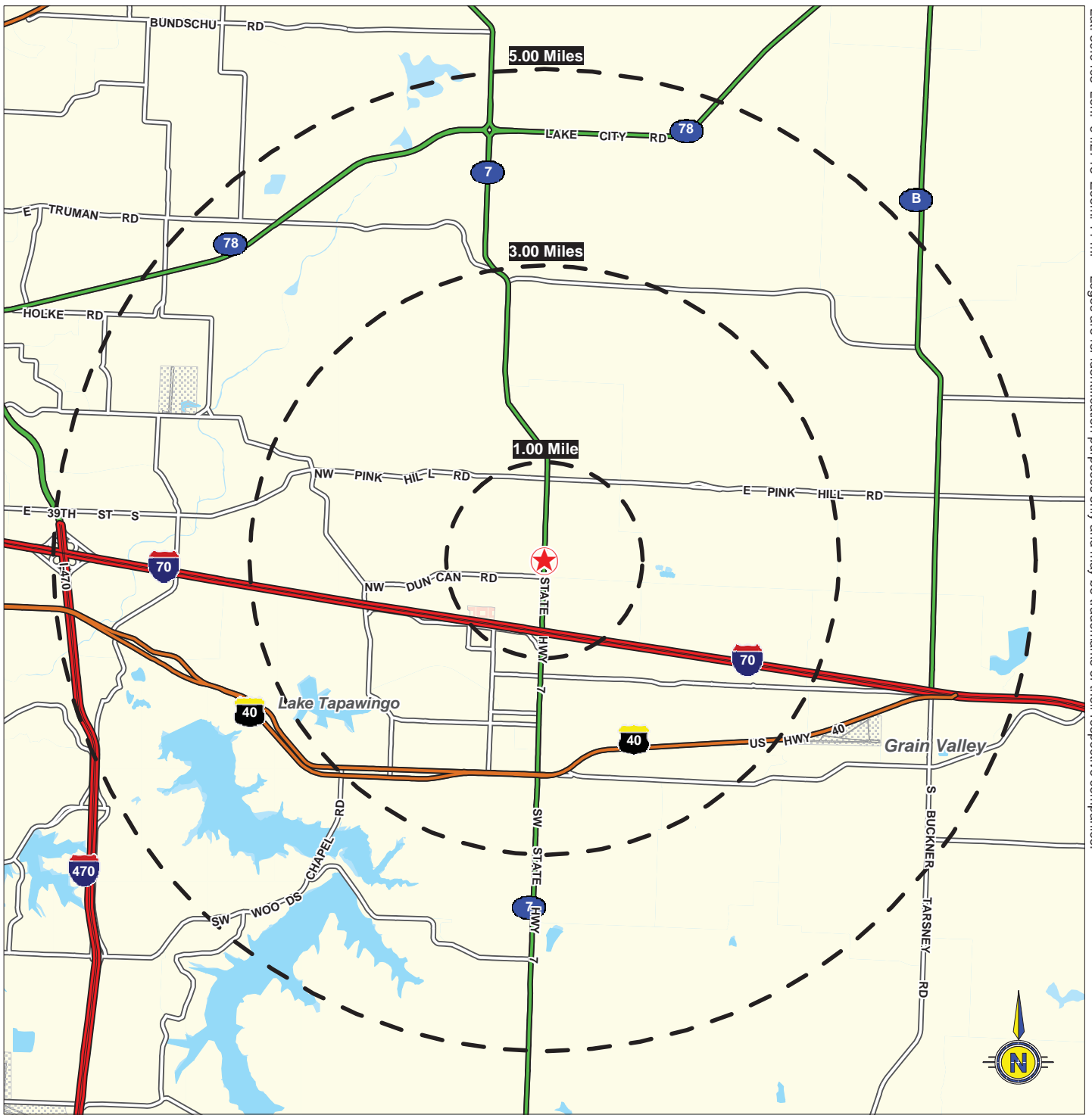

©2011, SITES USA Inc., Chandler, AZ (480) 491-1112. All Rights Reserved.

## 2100 N. M-7 Highway Blue Springs, Missouri

January 2011

This map was produced using data from private and government sources deemed to be reliable. The information herein is provided without representation or warranty.

# SUMMARY DEMOGRAPHIC PROFILE

1990 - 2000 Census, 2009 Estimates & 2014 Projections

Calculated using Proportional Block Groups

Lat/Lon: 39.04082/-94.271329

January 2011

RS1

2100 N. M-7 Highway Blue Springs, Missouri		1.00 mi radius	3.00 mi radius	5.00 mi radius
<b>POPULATION</b>	2009 Estimated Population	6,234	40,105	75,278
	2014 Projected Population	5,982	41,453	86,600
	2000 Census Population	6,293	37,632	64,294
	1990 Census Population	5,122	31,261	49,299
	Historical Annual Growth 1990 to 2009	1.1%	1.5%	2.8%
	Projected Annual Growth 2009 to 2014	-0.8%	0.7%	3.0%
	2009 Median Age	38.7	35.5	35.2
<b>HOUSEHOLDS</b>	2009 Estimated Households	2,305	14,724	27,506
	2014 Projected Households	2,211	15,121	31,489
	2000 Census Households	2,311	13,803	23,424
	1990 Census Households	1,734	10,858	16,930
	Historical Annual Growth 1990 to 2009	1.7%	1.9%	3.3%
	Projected Annual Growth 2009 to 2014	-0.8%	0.5%	2.9%
<b>POPULATION BY RACE</b>	2009 Estimated White	91.7%	92.2%	92.5%
	2009 Estimated Black or African American	4.1%	3.9%	3.6%
	2009 Estimated Asian & Pacific Islander	1.4%	1.2%	1.2%
	2009 Estimated American Indian & Native Alaskan	0.3%	0.3%	0.3%
	2009 Estimated Other Races	2.4%	2.4%	2.4%
	2009 Estimated Hispanic	6.3%	6.1%	6.1%
<b>INCOME</b>	2009 Estimated Average Household Income	\$ 83,734	\$ 71,220	\$ 70,958
	2009 Estimated Median Household Income	\$ 77,871	\$ 71,332	\$ 71,764
	2009 Estimated Per Capita Income	\$ 31,013	\$ 26,355	\$ 26,092
<b>EDUCATION (AGE 25+)</b>	2009 Elementary	0.7%	1.1%	1.2%
	2009 Some High School	4.0%	4.7%	5.0%
	2009 High School Graduate	28.3%	29.9%	31.4%
	2009 Some College	23.6%	24.2%	24.2%
	2009 Associates Degree Only	7.0%	8.4%	7.9%
	2009 Bachelors Degree Only	24.4%	21.8%	20.8%
	2009 Graduate Degree	12.0%	9.9%	9.6%
<b>BUSINESS</b>	Number of Businesses	184	1,525	2,776
	Total Number of Employees	1,660	16,674	32,567
	Employee Population per Business	9.0	10.9	11.7
	Residential Population per Business	33.8	26.3	27.1

This report was produced using data from private and government sources deemed to be reliable. The information herein is provided without representation or warranty.