

METCALF 75 SHOPPING CENTER

Retail Space For Lease



1,560 Sq Ft Available

Metcalfe Avenue at 75th Street (NWC), Overland Park, Kansas



Estimated Population
255,168

Average Household Income
\$77,363

Five Mile Radius

- Join CVS Pharmacy, Walgreen's, Price Chopper, Metcalf Bank, Verizon Wireless, Wyandotte BBQ, and 24 Hour Fitness at this busy intersection
- Excellent visibility
- 79,215 employees work within a three mile radius
- 75th Street carries over 32,000 cars per day and Metcalf Avenue carries over 34,000 cars per day

BLOCK & COMPANY, INC., Realtors 816.753.6000
In the Skelly Building on the Country Club Plaza
605 West 47th Street, Suite 200, Kansas City, Missouri 64112

For Information Contact:

Darren Siegel
816.412.7377
dsiegel@blockandco.com

75th Street & Metcalf Avenue, Overland Park, Kansas



Metcalfe Avenue at 75th Street (NWC), Overland Park, Kansas SURROUNDING TENANTS



Metcalf Avenue at 75th Street (NWC), Overland Park, Kansas

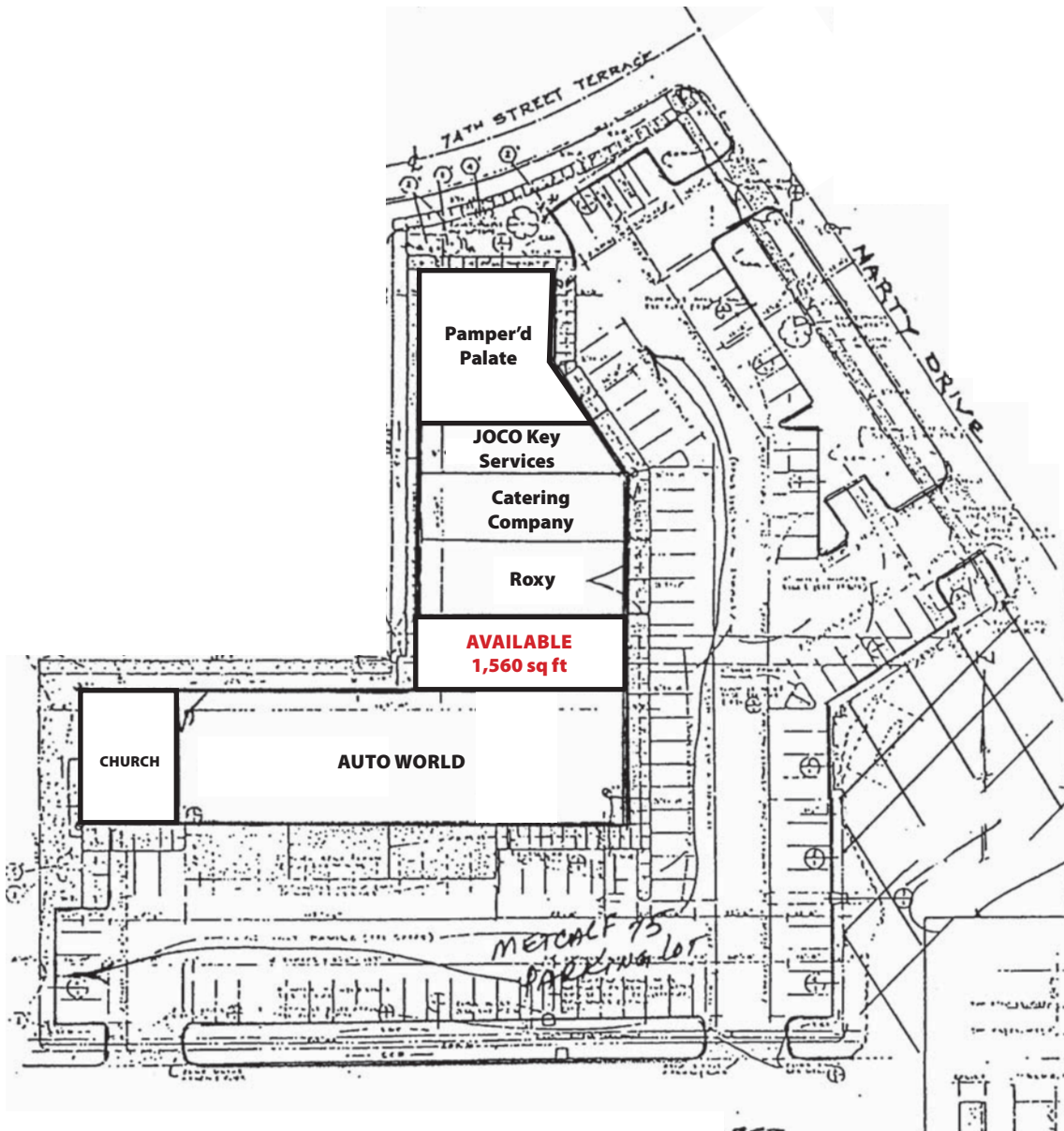

Lat: 38.9931 Lon: -94.6677 Zoom: 11 mi Logos are for identification purposes only and may be trademarks of their respective companies.



©2010, SITES USA Inc., Chandler, AZ (480) 491-1112. All Rights Reserved.

75th Street & Metcalf Avenue Overland Park, Kansas

February 2010

This map was produced using data from private and government sources deemed to be reliable. The information herein is provided without representation or warranty.

All information furnished regarding property for sale or lease is from sources deemed reliable, but no warranty or representation is made as to the accuracy thereof and the same is subject to errors, omissions, changes of prices, rental or other conditions, prior sale or lease or withdrawal without notice.

SUMMARY DEMOGRAPHIC PROFILE

1990 - 2000 Census, 2009 Estimates & 2014 Projections

Calculated using Proportional Block Groups

Lat/Lon: 38.99313/-94.66772

March 2011

RS1

75th Street & Metcalf Avenue Overland Park, Kansas		1.00 mi radius	3.00 mi radius	5.00 mi radius
POPULATION	2009 Estimated Population	11,903	96,154	255,168
	2014 Projected Population	12,806	97,811	255,720
	2000 Census Population	11,917	99,326	262,627
	1990 Census Population	12,550	103,596	268,077
	Historical Annual Growth 1990 to 2009	-0.3%	-0.4%	-0.3%
	Projected Annual Growth 2009 to 2014	1.5%	0.3%	0.0%
	2009 Median Age	39.4	40.2	40.2
HOUSEHOLDS	2009 Estimated Households	5,151	41,577	107,020
	2014 Projected Households	5,088	38,889	100,681
	2000 Census Households	5,381	44,755	113,712
	1990 Census Households	5,367	44,923	111,616
	Historical Annual Growth 1990 to 2009	-0.2%	-0.4%	-0.2%
	Projected Annual Growth 2009 to 2014	-0.2%	-1.3%	-1.2%
POPULATION BY RACE	2009 Estimated White	86.9%	85.0%	84.4%
	2009 Estimated Black or African American	4.0%	5.1%	6.2%
	2009 Estimated Asian & Pacific Islander	2.2%	2.8%	2.9%
	2009 Estimated American Indian & Native Alaskan	0.9%	0.8%	0.6%
	2009 Estimated Other Races	6.1%	6.4%	5.8%
	2009 Estimated Hispanic	8.3%	7.9%	8.8%
INCOME	2009 Estimated Average Household Income	\$ 59,182	\$ 71,282	\$ 77,363
	2009 Estimated Median Household Income	\$ 59,402	\$ 68,275	\$ 72,951
	2009 Estimated Per Capita Income	\$ 26,641	\$ 31,372	\$ 33,023
EDUCATION (AGE 25+)	2009 Elementary	2.0%	1.4%	1.4%
	2009 Some High School	3.5%	2.6%	3.1%
	2009 High School Graduate	22.3%	19.1%	19.5%
	2009 Some College	25.4%	22.8%	21.2%
	2009 Associates Degree Only	7.6%	7.2%	7.1%
	2009 Bachelors Degree Only	28.2%	31.8%	31.1%
	2009 Graduate Degree	11.1%	15.2%	16.7%
BUSINESS	Number of Businesses	530	5,549	14,056
	Total Number of Employees	6,777	79,215	191,087
	Employee Population per Business	12.8	14.3	13.6
	Residential Population per Business	22.4	17.3	18.2

This report was produced using data from private and government sources deemed to be reliable. The information herein is provided without representation or warranty.